

Surface mounted downlighters ABD 195 ... SG, ABD 235 ... SG for compact fluorescent lamps

Luminaire housing: Cylindrical housing made of aluminium, gear tray plate, and lower housing ring with integrated bayonet facility for fitting decorative trim attachments. The housing is white powder coated.

Electrical equipment:

- Ballasts (KVG/VVG), 230 V, 50 Hz or with electronic ballasts (EVG) 220-240 V, 0/50-60 Hz
- Radio interference suppression in accordance with EC directives
- Prepared for parallel power factor correction with accessory 0207700
- Connector block 5x2.5 mm²

Mounting:

The luminaire is designed for individual ceiling mounting. Screws and other fastening material are to be provided on site.

Accessories, retrofit kits:

For a detailed description of decorative trims, see pages 492 to 496.

Application:

The round shape of the luminaire blends ideally into any room style. These luminaires may consequently be used in corridors, foyers, conference rooms, sales showrooms and offices.

Lighting technology:

Luminance cut-off at $L \leq 200 \text{ cd/m}^2$ for angles greater than $\gamma \geq 60^\circ$ to the vertical without compromising the light output ratio.

Use of the louvre REBDT/K/R... S reduces luminance to $L \leq 200 \text{ cd/m}^2$ for angles of $\gamma \geq 55^\circ$ to the vertical.

Special versions:

The luminaires are available in the following special versions in response to customer request and against a surcharge:

- Non-standard colours according to the RAL colour chart
- Prefitted dimmable electronic ballasts.
- Versions for central or integral emergency operation in maintained or non-maintained mode.

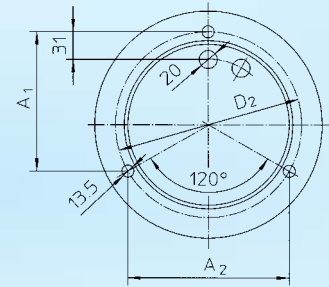
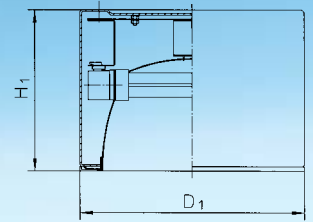

Voltage	220 - 240 V
Protection class	IP 20
Approvals	

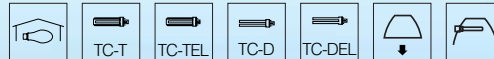

Reflector SG:

Anodised silver "SG"

Parabolic reflector made of specular anodised super-purity aluminium. Luminance cut-off at $L \leq 200 \text{ cd/m}^2$ for angles of $\gamma \geq 60^\circ$ to the vertical, depending on the lamps used.

For the latest data, visit www.ridi.de



Reflector SGF:

Anodised silver "SGF"

Parabolic reflector made of anodised super-purity aluminium with specular faceted surface. Extremely decorative appearance.



Reflector SM:

Anodised silver "SM"

Parabolic reflector made of anodised super-purity aluminium with satin finish.



Reflector W:

White painted "W"

Made of aluminium with a matt white finish.

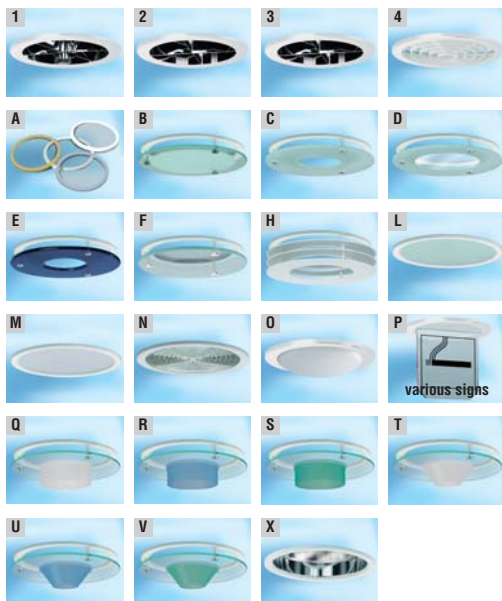

Useable decorative trims	Pr. code for ABD 195	Pr. code for ABD 235
1 REBDT...S	0202658	0202659
2 REBDK...S	0202662	0202663
3 REBDR...S	0202666	0202667
4 REBDR...W	0202670	0202671
A DR...W	0202675	0202676
DR...SM	0202675//607	0202676//607
DR...SG	0202675//609	0202676//609
DR...AL	0202675//634	0202676//634
DR...ES	0202675//636	0202676//636
DR...RAL	0202675//RAL	0202676//RAL
B DG...W	0202683	0202684
C DGS...W	0202692	0202693
D DSG...W	0202701	0202702
E DGFB...W	0202710	0202711

Useable decorative trims	Pr. code for ABD 195	Pr. code for ABD 235
F DGB...W	0202719	0202720
H DVW3...W	0202727	0202728
L DGD...W	0202734	0202735
M DGOD...W	0202739	0202740
N DVRP...W	0202744	0202745
O DKV5...W	0202748	0202749
P DVHW...WNR1-24	0202802	0202803
Q DGS...W	0202752	0202753
R DGZB...W	0202756	0202757
S DGZG...W	0202760	0202761
T DGKS...W	0202764	0202765
U DGKB...W	0202768	0202769
V DGKG...W	0202772	0202773
X DVZS...W	0202778	0202779

Note: Finish of the visible surface of decorative trims type A :
 DR...W, white
 DR...AL, natural aluminium colour,
 DR...SM, matt silver
 DR...ES, natural stainless steel colour,
 DR...SG, specular silver
 DR...RAL, painted in accordance with the RAL colour chart.

For a description of decorative trims / accessories, see pages 492 to 496.



ABD 195/... SG

Standard version surface mounted downlighter with reflector **SG** and white plastic cover ring (PA).

Note:

Surface mounted downlighters are supplied as standard with the reflector **"SG"**.
Luminaires fitted with reflectors **"SGF"**, **"SM"** and **"W"** are special order models. The order data can be simply derived from the standard type.

Example:

Standard type with reflector **"SG"**
Prod. code x30xxxx
Special order types with reflector **"SGF"**
Prod. code x30xxxx/608
Special order types with reflector **"SM"**
Prod. code x30xxxx/607
Special order types with reflector **"W"**
Prod. code x30xxxx/638
Other cover rings in accordance with the table item **"A"** are available on request or as retrofit accessories.

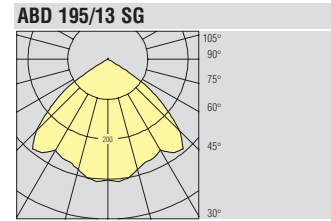

Quick calculation table (Reflectances: 70/ 50/ 20)

E in lux	MH in m	Room area in m²								
		20	30	40	50	70	80	90	100	
300	1,65	17	24	31	37	50	56	63	69	
	2,15	19	26	33	40	53	60	66	73	
	2,65	22	29	36	42	56	63	70	76	
500	1,65	28	40	51	62	83	94	104	115	
	2,15	32	43	54	66	88	99	110	121	
	2,65	36	48	59	70	93	104	116	127	

Maintenance factor: 0,67

►► Lighting data: www.ridi.de

Model	Lamps	Lampholder	Dimensions [mm]					Weight [kg]	Prod. code with KVG	Prod. code with VVG	Prod. code with EVG
			D ₁	H ₁	D ₂	A ₁	A ₂				
ABD 195/13 SG	1xTC-D/10,13W	G24d-1	195	155	166	144	125	1,7	1305302		
ABD 195/2x13 SG	2xTC-D/10,13W	G24d-1	195	155	166	144	125	1,9	1300469		
ABD 195/18 SG	1xTC-D/T/18W	G24d-2	195	155	166	144	125	1,7		1310470	
ABD 195/13 SG-EVG	1xTC-DEL/10,13W	G24q-1	195	155	166	144	125	1,5			1325302
ABD 195/2x13 SG-EVG	2xTC-DEL/10,13W	G24q-1	195	155	166	144	125	1,9			1320469
ABD 195/18 SG-EVG	1xTC-DEL/TEL/18W	G24q-2	195	155	166	144	125	1,7			1320470
ABD 195/26 SG-EVG	1xTC-TEL/26W	G24q-3	195	155	166	144	125	1,7			1320726



ABD 235/... SG

Standard version surface mounted downlighter with reflector **SG** and white plastic cover ring (PA).

Note:

Surface mounted downlighters are supplied as standard with the reflector **"SG"**.
Luminaires fitted with reflectors **"SGF"**, **"SM"** and **"W"** are special order models. The order data can be simply derived from the standard type.

Example:

Standard type with reflector **"SG"**
Prod. code x30xxxx
Special order types with reflector **"SGF"**
Prod. code x30xxxx/608
Special order types with reflector **"SM"**
Prod. code x30xxxx/607
Special order types with reflector **"W"**
Prod. code x30xxxx/638
Other cover rings in accordance with the table item **"A"** are available on request or as retrofit accessories.

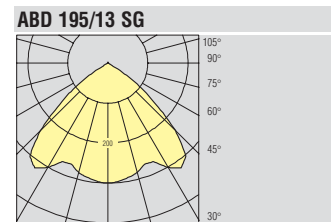

Quick calculation table (Reflectances: 70/ 50/ 20)

E in lux	MH in m	Room area in m²								
		20	30	40	50	70	80	90	100	
300	1,65	13	18	24	29	39	44	48	53	
	2,15	15	20	25	31	41	46	51	56	
	2,65	17	22	27	33	43	48	54	59	
500	1,65	22	30	39	48	64	72	80	88	
	2,15	25	33	42	51	68	76	85	93	
	2,65	27	37	45	54	71	80	89	98	

Maintenance factor: 0,67

►► Lighting data: www.ridi.de

Model	Lamps	Lampholder	Dimensions [mm]					Weight [kg]	Prod. code with KVG	Prod. code with VVG	Prod. code with EVG
			D ₁	H ₁	D ₂	A ₁	A ₂				
ABD 235/2x13 SG	2xTC-D/10,13W	G24d-1	235	180	206	178	155	2,5	1305307		
ABD 235/18 SG	1xTC-D/T/18W	G24d-2	235	180	206	178	155	2,2		1315306	
ABD 235/2x18 SG	2xTC-D/T/18W	G24d-2	235	180	206	178	155	2,7		1316419	
ABD 235/26 SG	1xTC-T/26W	G24d-3	235	180	206	178	155	2,5		1310479	
ABD 235/2x26 SG	2xTC-D/26W	G24d-3	235	180	206	178	155	2,7		1310480	
ABD 235/2x13 SG-EVG	2xTC-DEL/10,13W	G24q-1	235	180	206	178	155	2,3			1325307
ABD 235/18 SG-EVG	1xTC-DEL/TEL/18W	G24q-2	235	180	206	178	155	2,3			1325306
ABD 235/2x18 SG-EVG	2xTC-DEL/TEL/18W	G24q-2	235	180	206	178	155	2,3			1326419
ABD 235/2x26 SG-EVG	2xTC-TEL/26W	G24q-3	235	180	206	178	155	2,3			1320480
ABD 235/26-42 SG-EVG*	1xTC-TEL/26,32,42W	G24Xq-3/4	235	180	206	178	155	2,3			0320727

*Prefitted multi-watt EVG

